



RERA Approved: K-RERA/PRJ/KKD/205/2022

An abode where the city
merges with **serenity**



ALTURA
Premium Apartments

KOTTOOLI, KOZHIKODE

www.pinnacle-projects.com



Interiors to inspire
you everyday
to stay cheerful



ALTURA

Premium Apartments



A home on the heights with higher views !

Altura, a premium project from **Pinnacle Projects** is your choice. Situated in a scenic landscape within the city where all essential facilities are in a walkable reach. The twenty-eight carefully designed homes are meant for a perfect everyday getaway niche. All the in-house amenities are tailor-made to provide you beautiful social time without stepping out the compound. Immerse into the breeze, the joyful chirping of birds and enjoy every other luxury a well-settled residential area offers



A place

not far from anywhere still
a place to unwind and relax





Terrace floor Plan

ALTURA
Premium Apartments



Ground floor Plan



- A
- B
- C
- D
- E
- F
- G

Typical floor Plan (1st to 4th)

TYPE A

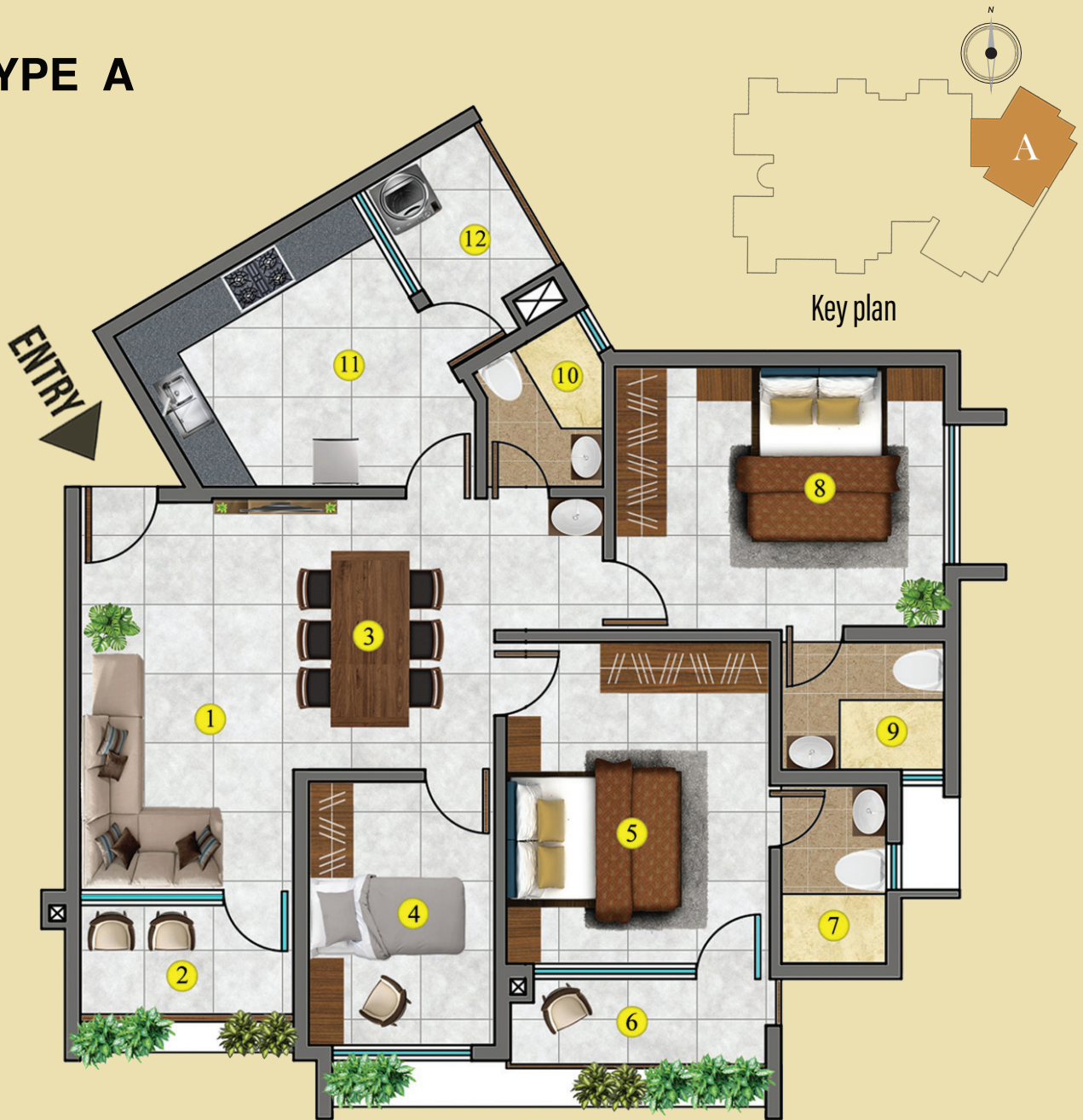

Carpet Area (RERA) : 989 sqft
 Exclusive Area : 174 sqft
 Super Builtup Area : 1439 sqft

LEGENDS

1	Drawing	275 x 500
2	Balcony	275 x 150
3	Dining	260 x 350
4	Bedroom	240 x 340
5	Bedroom	340 x 415
6	Balcony	330 x 115
7	Toilet	135 x 230
8	Bedroom	425 x 340
9	Toilet	210 x 165
10	Toilet	150 x 195
11	Kitchen	354 x 350
12	Work Area	172 x 212

Disclaimer : Furnitures shown are for presentation purpose only.

ALTURA
 Premium Apartments

TYPE B

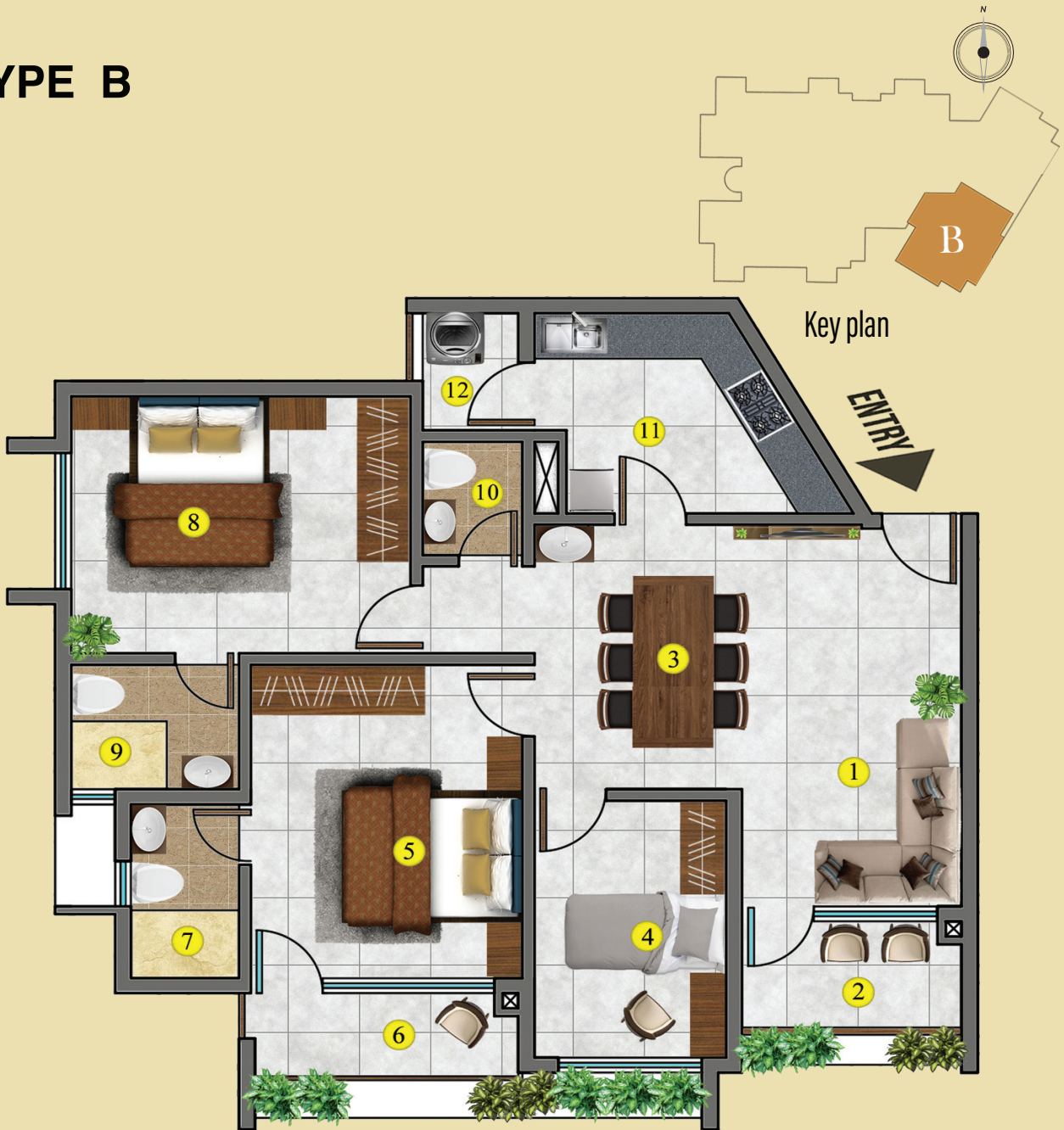

Carpet Area (RERA) : 914 sqft
 Exclusive Area : 173 sqft
 Super Builtup Area : 1344 sqft

LEGENDS

1	Drawing	275 x 500
2	Balcony	275 x 150
3	Dining	260 x 350
4	Bedroom	240 x 340
5	Bedroom	340 x 415
6	Balcony	330 x 115
7	Toilet	135 x 230
8	Bedroom	425 x 340
9	Toilet	210 x 165
10	Toilet	125 x 150
11	Kitchen	310 x 265
12	Work Area	120 x 155

Disclaimer : Furnitures shown are for presentation purpose only.

ALTURA
Premium Apartments

TYPE C,F,G

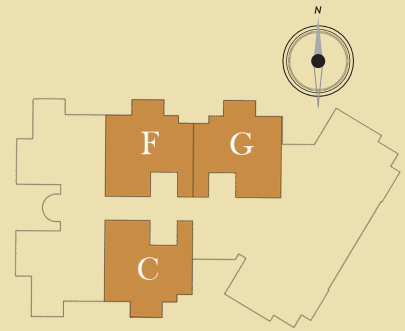

Key plan



Carpet Area (RERA) : 678 sqft
 Exclusive Area : 176 sqft
 Super Builtup Area : 1056 sqft

LEGENDS

1	Drawing	385 x 270
2	Balcony	210 x 270
3	Dining	320 x 235
4	Bedroom	395 x 305
5	Toilet	235 x 135
6	Bedroom	320 x 390
7	Balcony	200 x 150
8	Toilet	265 x 150
9	Airshaft	270 x 290
10	Kitchen	270 x 305

Disclaimer : Furnitures shown are for presentation purpose only.

TYPE D,E

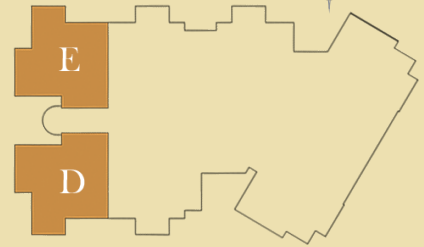

Key plan

ENTRY 



LEGENDS

1	Drawing	405 x 275
2	Balcony	140 x 275
3	Dining	290 x 260
4	Bedroom	375 x 300
5	Toilet	240 x 135
6	Bedroom	290 x 365
7	Balcony	170 x 170
8	Toilet	150 x 245
9	Kitchen	270 x 310

Carpent Area (RERA)	:	672 sqft
Exclusive Area	:	147 sqft
Super Builtup Area	:	1013 sqft

Disclaimer : Furnitures shown are for presentation purpose only.

ALTURA
Premium Apartments

Specifications

Structure	: RCC framed structure with laterite or cement block walls
Flooring	: Vitrified tiles for apartments & common areas. Anti skid tiles for toilets and balconies
Wall tiles	: Glazed / Vitrified tiles for toilet walls up to a height of 7 feet
Kitchen	: SS Sink, Granite counter top and glazed tiles upto 60 cm above work top
Door	: Main Door - Hardwood frame with veneer finish flush door Other Doors - Hardwood frame with ready made shutter
Windows & Ventilators	: Powder coated aluminum frames and sliding shutters with glass and MS grills
Hardware	: SS hinges, tower bolts, mortise locks as applicable
Handrails	: Designer handrail using MS sections
Painting	: Interiors- putty finished emulsion. Exteriors- weather proof emulsion Doors/handrails/grills- enamel paint
Electrification	: Concealed wiring for light, fan and plug points. Modular switches, 3 phase connection with independent KSEB meters, Generator backup for selected points.
Plumbing	: Concealed plumbing with PVC pipes. CP faucets and tap fittings
Sanitary wares	: White ceramic sanitary wares as applicable.
Sewage disposal	: Common Sewage treatment plant
Water supply	: Water source - Common KWA connection subject to approval. Roof top common water tank
Yard	: Concrete interlocking pavers. All round compound wall. Designer main gate using MS sections
Common amenities	: Entrance lobby, gymnasium, association room, children's play area & landscaped front terrace

Location Map

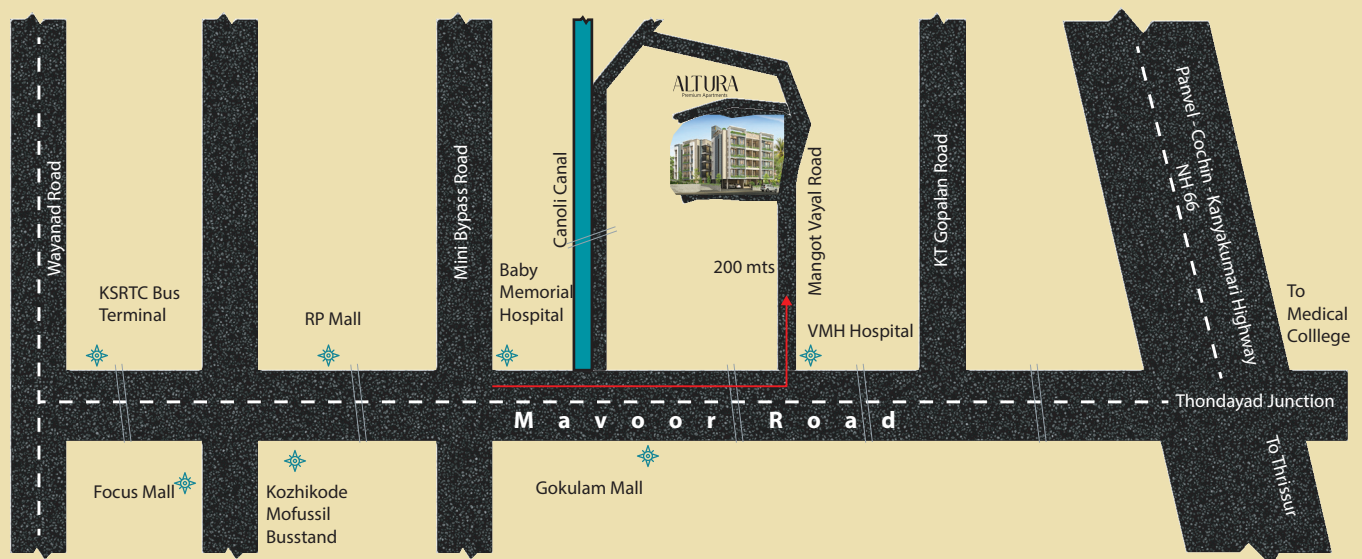

Key Distance:

◆ Railway Station	5 km	◆ Medical College	5 km	◆ Hilite Mall	6 km
◆ Airport	25 km	◆ Baby Memorial Hospital	1.5 km	◆ RP Mall	2 km
◆ Mofussil Bus Stand	2 km	◆ Meitra Hospital	9 km	◆ Focus Mall	2 km
◆ KSRTC Bus Stand	2.5 km	◆ Sarovaram Biopark	2 km		
◆ Beach	4.5 km	◆ Gokulam Mall	1.5 km		



Pinnacle Projects ingrained in the soil of Kozhikode for 10 years have been successful in constructing unique homes and other spaces. We are acing the industry by assimilation of our clients' vision and its implementation in quality. Every brick we laid are with an essence of this land's honesty. **Pinnacle Projects** have triumphantly completed many constructional ventures in and around Kozhikode, Kochi and Malappuram.



✉ sales@pinnacle-projects.com



🌐 www.pinnacle-projects.com



📍 62/1025, Red Cross Road, Calicut - 673 032
 📞 +91- 495 - 2766113, Mob : +91 96334 99113
 +91 96332 29113

Architects:

